

# City Commission Approved Contamination & Known Contamination Sites

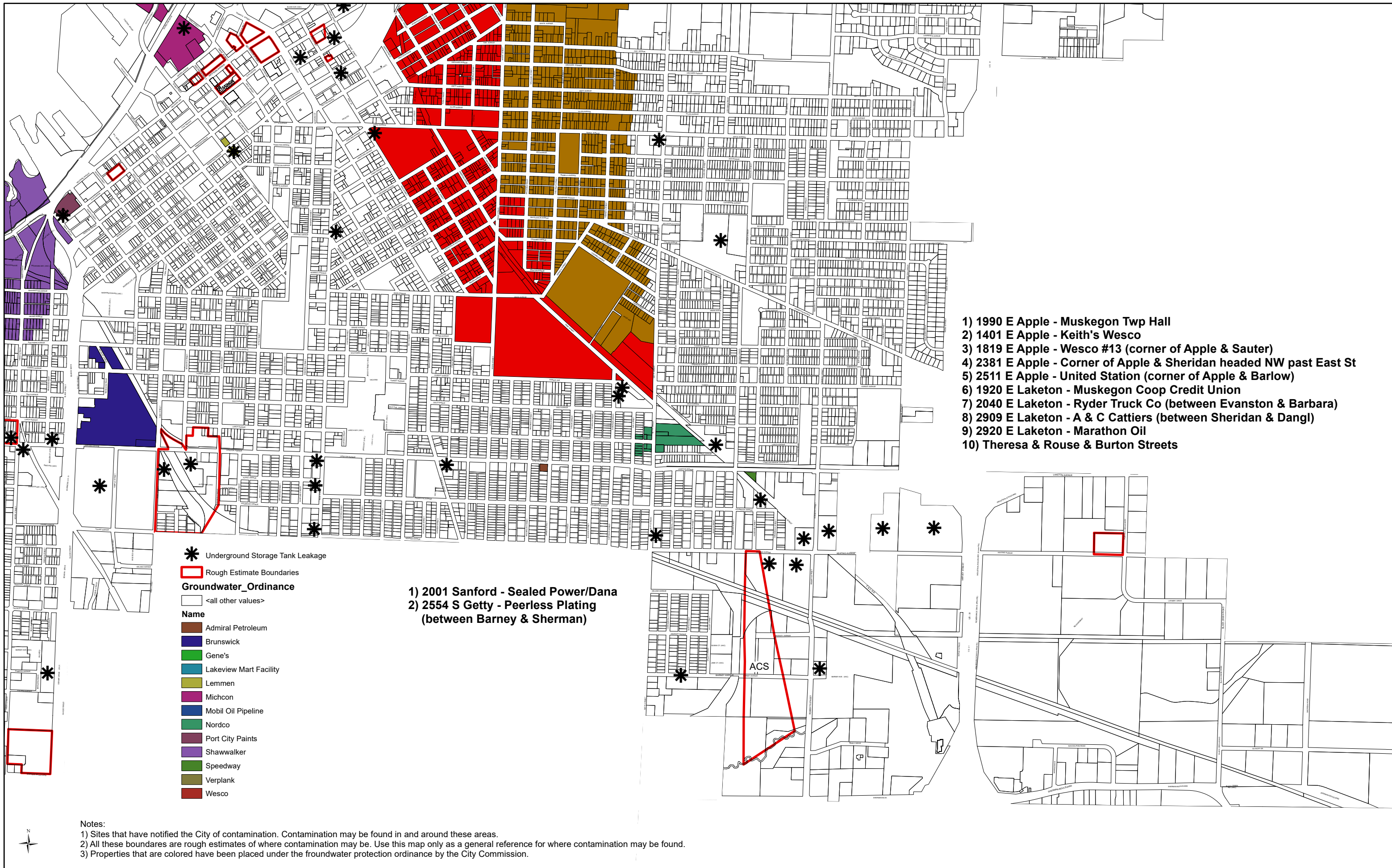

- 1) 1990 E Apple - Muskegon Twp Hall
- 2) 1401 E Apple - Keith's Wesco
- 3) 1819 E Apple - Wesco #13 (corner of Apple & Sauter)
- 4) 2381 E Apple - Corner of Apple & Sheridan headed NW past East St
- 5) 2511 E Apple - United Station (corner of Apple & Barlow)
- 6) 1920 E Laketon - Muskegon Coop Credit Union
- 7) 2040 E Laketon - Ryder Truck Co (between Evanston & Barbara)
- 8) 2909 E Laketon - A & C Cattiers (between Sheridan & Dangl)
- 9) 2920 E Laketon - Marathon Oil
- 10) Theresa & Rouse & Burton Streets

- \* Underground Storage Tank Leakage
- ▭ Rough Estimate Boundaries
- Groundwater Ordinance**
- ▭ <all other values>
- Name**
- ▭ Admiral Petroleum
- ▭ Brunswick
- ▭ Gene's
- ▭ Lakeview Mart Facility
- ▭ Lemmen
- ▭ Michcon
- ▭ Mobil Oil Pipeline
- ▭ Nordco
- ▭ Port City Paints
- ▭ Shawwalker
- ▭ Speedway
- ▭ Verplank
- ▭ Wesco

- 1) 2001 Sanford - Sealed Power/Dana
- 2) 2554 S Getty - Peerless Plating (between Barney & Sherman)

**Notes:**  
 1) Sites that have notified the City of contamination. Contamination may be found in and around these areas.  
 2) All these boundaries are rough estimates of where contamination may be. Use this map only as a general reference for where contamination may be found.  
 3) Properties that are colored have been placed under the groundwater protection ordinance by the City Commission.