

SITE PLAN FOR STAIRS AND LANDINGS AT NORMAN F KRUSE PARK

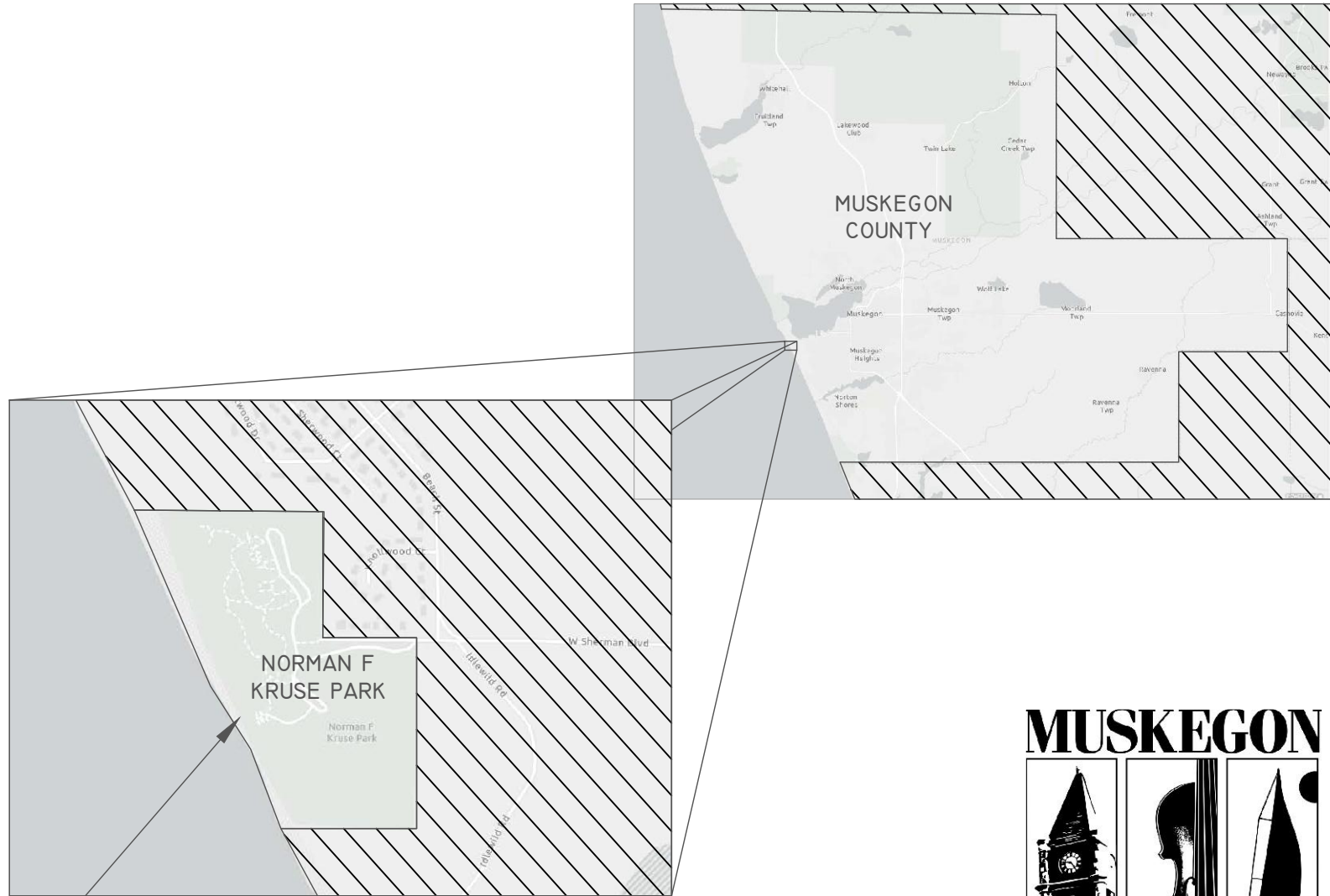

**PROJECT
LOCATION**
3205 W. SHERMAN BLVD.
MUSKEGON, MI 49441

MUSKEGON



West Michigan's Shoreline City
www.shorelinecity.com

NOTES

Date:

Revisions:

Drawn: K. PARKER
Date: 12/29/2023
Checked:
Date:

NOT TO SCALE

STAIRS AND LANDINGS
KRUSE PARK

CITY OF MUSKEGON
OFFICE OF THE CITY ENGINEER

1
OF 4

SITE PLAN FOR STAIRS AND LANDINGS

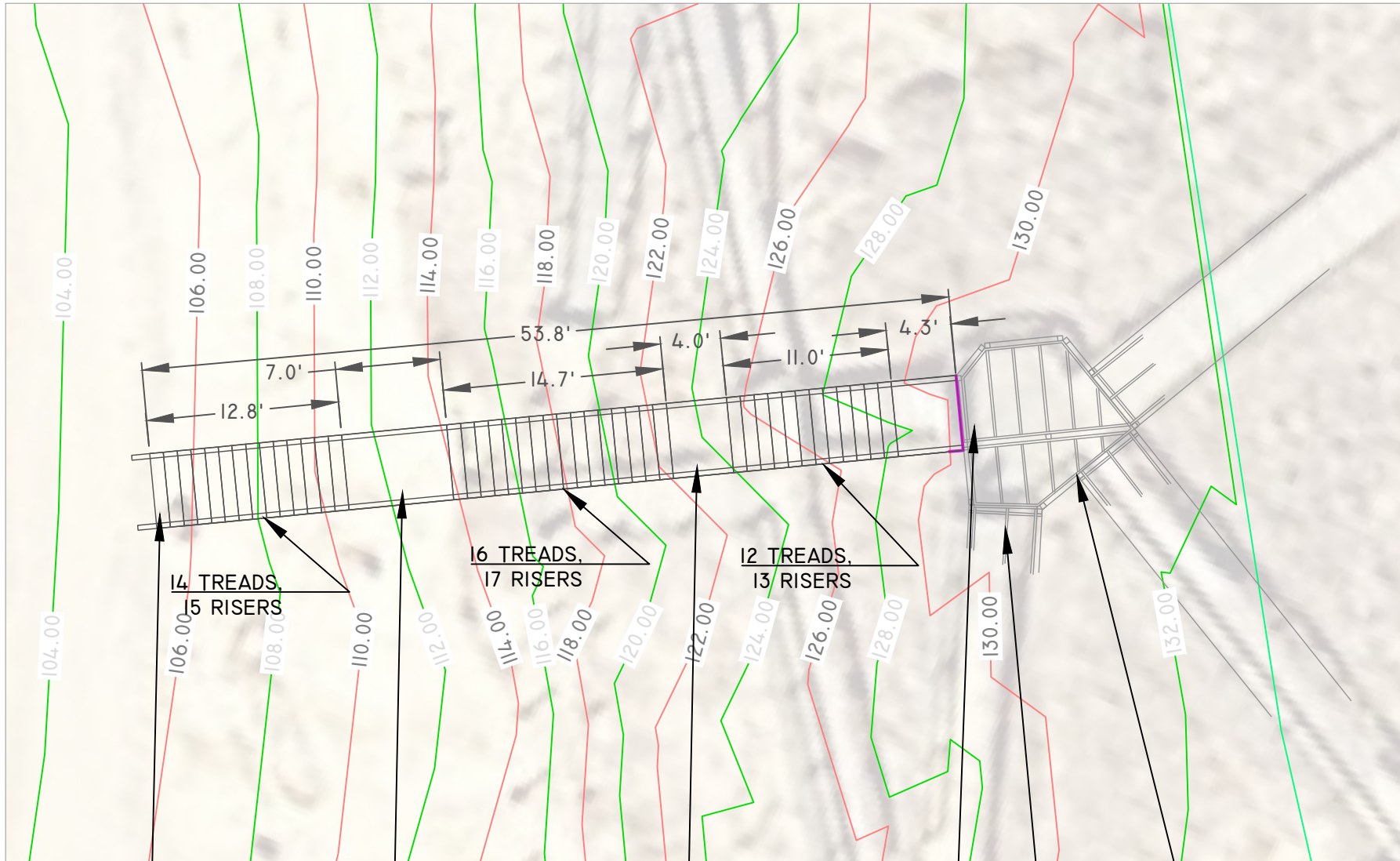
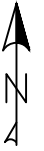

LANDING EL.
105.02

LANDING EL.
113.77

LANDING EL.
123.69

LANDING EL.
131.28

EXISTING
PATHWAY LANDING

THE CONTRACTOR IS REQUIRED TO ACQUIRE ANY NECESSARY PERMITS.
LAYOUT OF STAIRS IS BASED ON BEST AVAILABLE INFORMATION. REVISIONS TO NUMBER OF STAIRS,
LENGTH OF BOARDWALKS OR LANDINGS, ETC. ARE EXPECTED AND WILL BE ADJUSTED BASED ON FIELD
CONDITIONS ONLY WITH CITY ENGINEER APPROVAL.
ELEVATIONS FROM SURVEY ARE NOT STATE PLANE.

SECTION REMOVED,
WILL NEED ADDITIONAL
BOARDS FOR PROPER CLOSURE

NOTES:
Date: _____
Revisions:
1. _____
2. _____
3. _____
Drawn: K. PARLIER
Date: 7/29/2023
Checked: _____
Date: _____

STAIR TOPO OVERLAY
NOT TO SCALE

STAIRS AND LANDINGS
KRUSE PARK

CITY OF MUSKEGON
OFFICE OF THE CITY ENGINEER



TYPICAL STAIR DETAIL

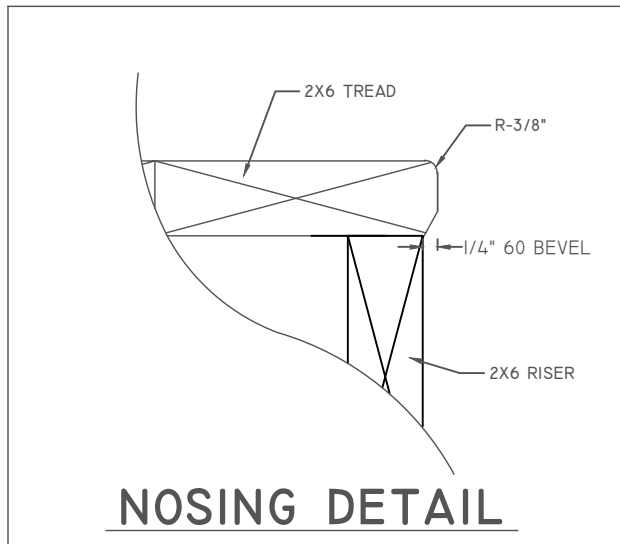
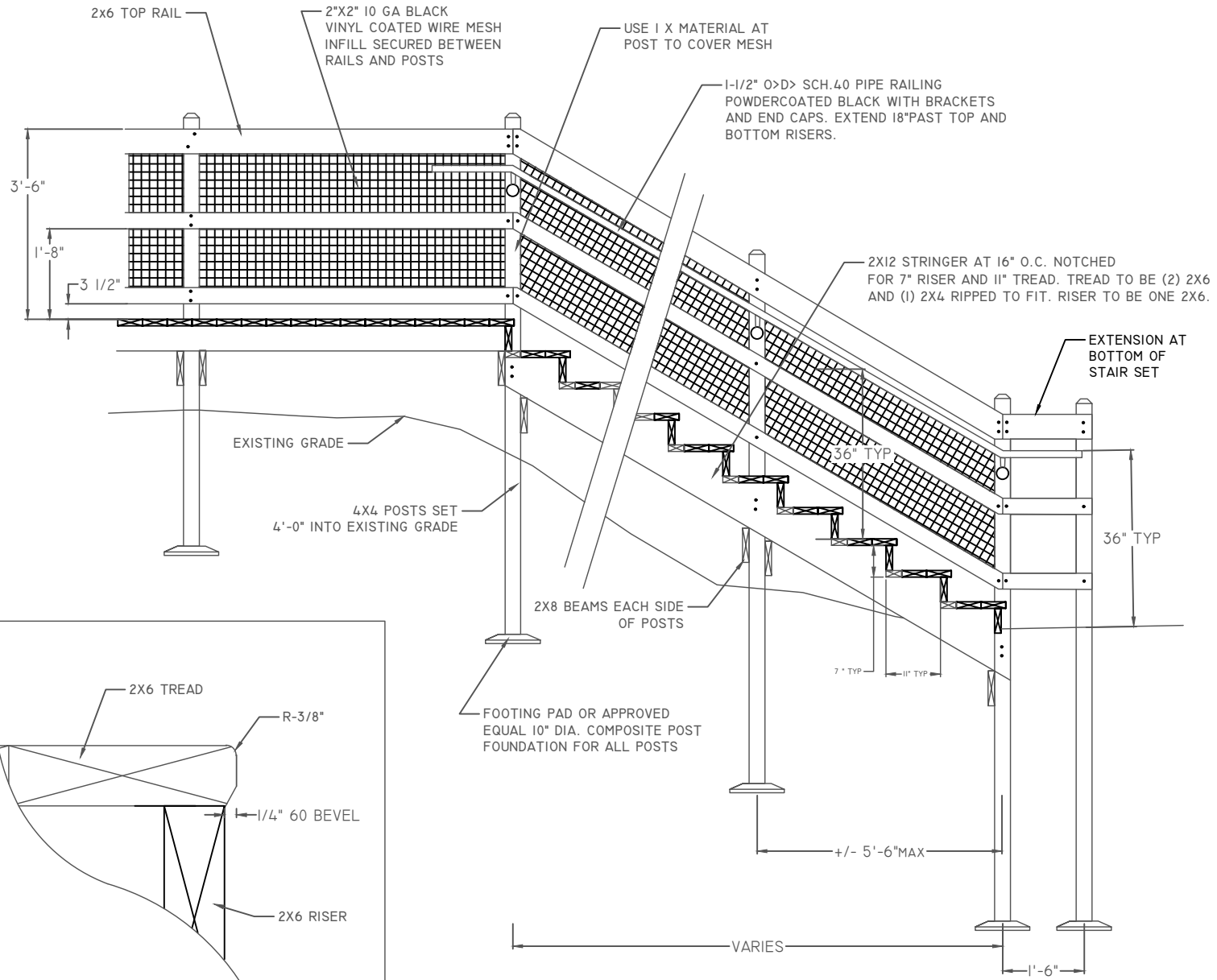

NOSING DETAIL

NOTES:

Date:

Revisions:

1.

2.

3.

Drawn by PARKER

Checked by:

Date:

STAIR DETAIL
NOT TO SCALE

STAIRS AND LANDINGS
KRUSE PARK

CITY OF MUSKEGON
OFFICE OF THE CITY ENGINEER

3
OF 4



West Michigan's Shoreline City
www.shorelinecity.com

TYPICAL BOARDWALK DETAIL

TIE TO EXISTING DETAIL

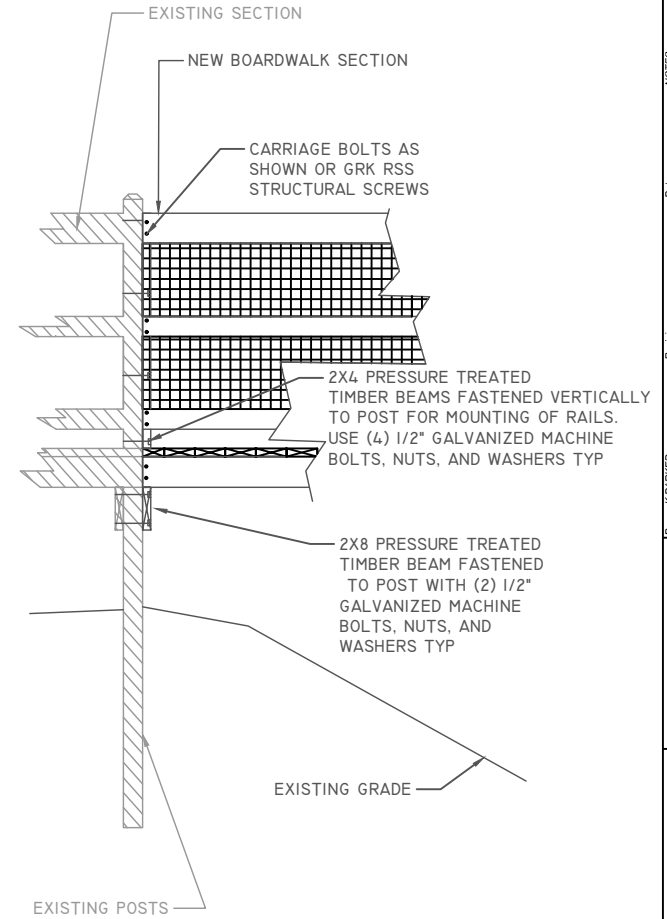
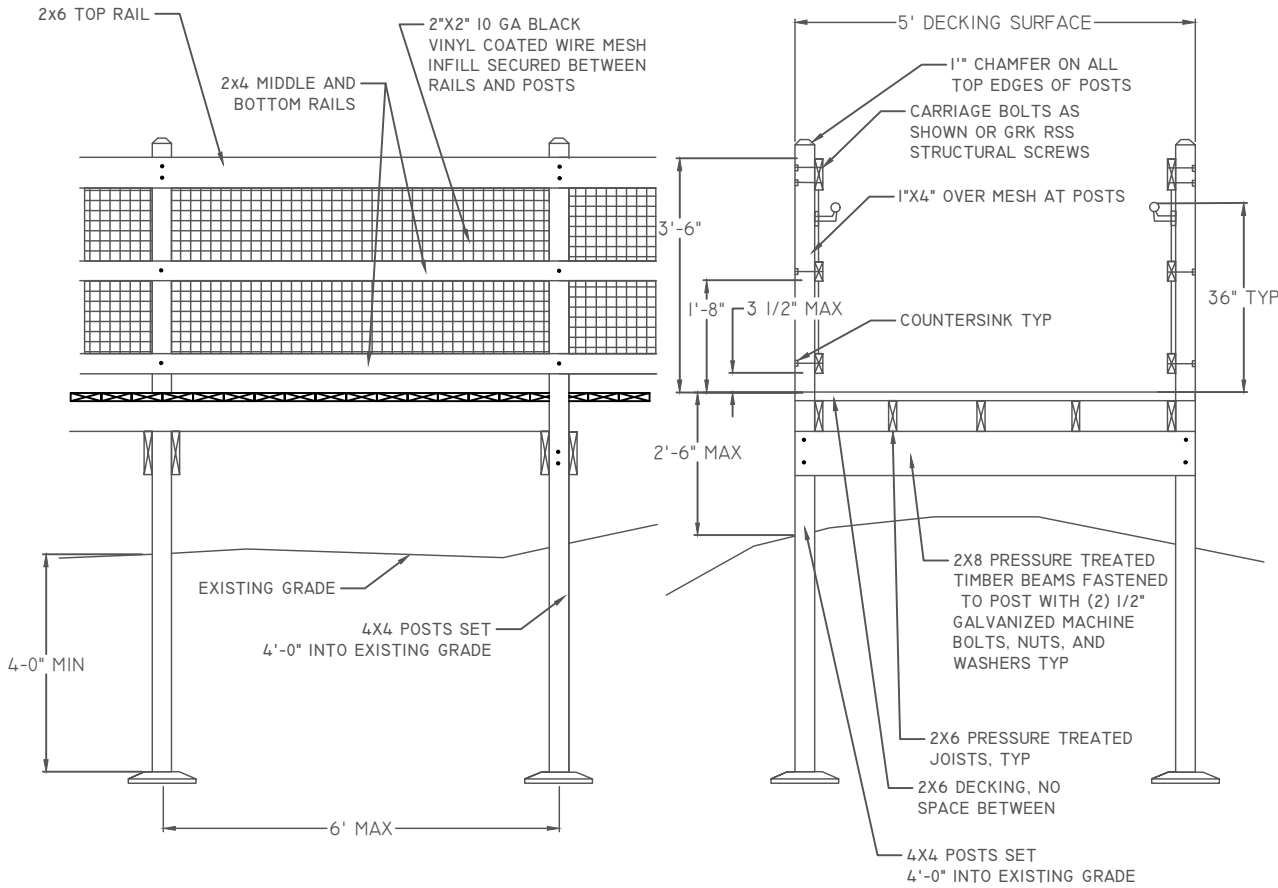

NOTES:

Date:

Revisions:

1

2

3

Drawn by: PARKER

Checked:

Date:

BOARDWALK DETAIL

NOT TO SCALE

STAIRS AND LANDINGS

KRUSE PARK

CITY OF MUSKEGON

OFFICE OF THE CITY ENGINEER

4

OF 4

